

Powered by



**egypt  
facility  
management  
forum. 7<sup>th</sup>**



**12<sup>th</sup> & 13<sup>th</sup> MAY 2026  
KEMPINSKI HOTEL  
NEW CAIRO**

Presentation Title Here: Why Washroom

Hygiene Fail

Presenter Name: Omar Morsi

Title: GM

Company: Dynachem



# Why Washroom Hygiene Fails

# A Question for This

Room  
When was the last time you walked into a public washroom in Egypt — a government building, a hospital, a transport hub — and thought: *this is exactly what it should be?*

Most of us can't remember. And we work in this industry. That's not a coincidence — that's a signal.



**FIRST  
TIMES  
TESTS  
ON**

**You can tell where you are...**

**just by entering a**

**washroom.**

# The Real Question Why does a 5-star washroom *feel*

5 STAR LOBBY WASHROOM

VS

AIRPORT WASHROOM



**Everyone smells  
the failure.**

**Nobody sees the system.**

**"Looks clean"  
is not hygienic.**

Surfaces that appear spotless harbor biofilm,  
pathogens, and odor-causing residue — invisible to the  
eye, undeniable to the nose.

**Shine can hide what bacteria  
cannot.**



# The Myth

Cleaning more = Better  
hygiene ~~X~~  
Frequency alone doesn't fix a broken system.

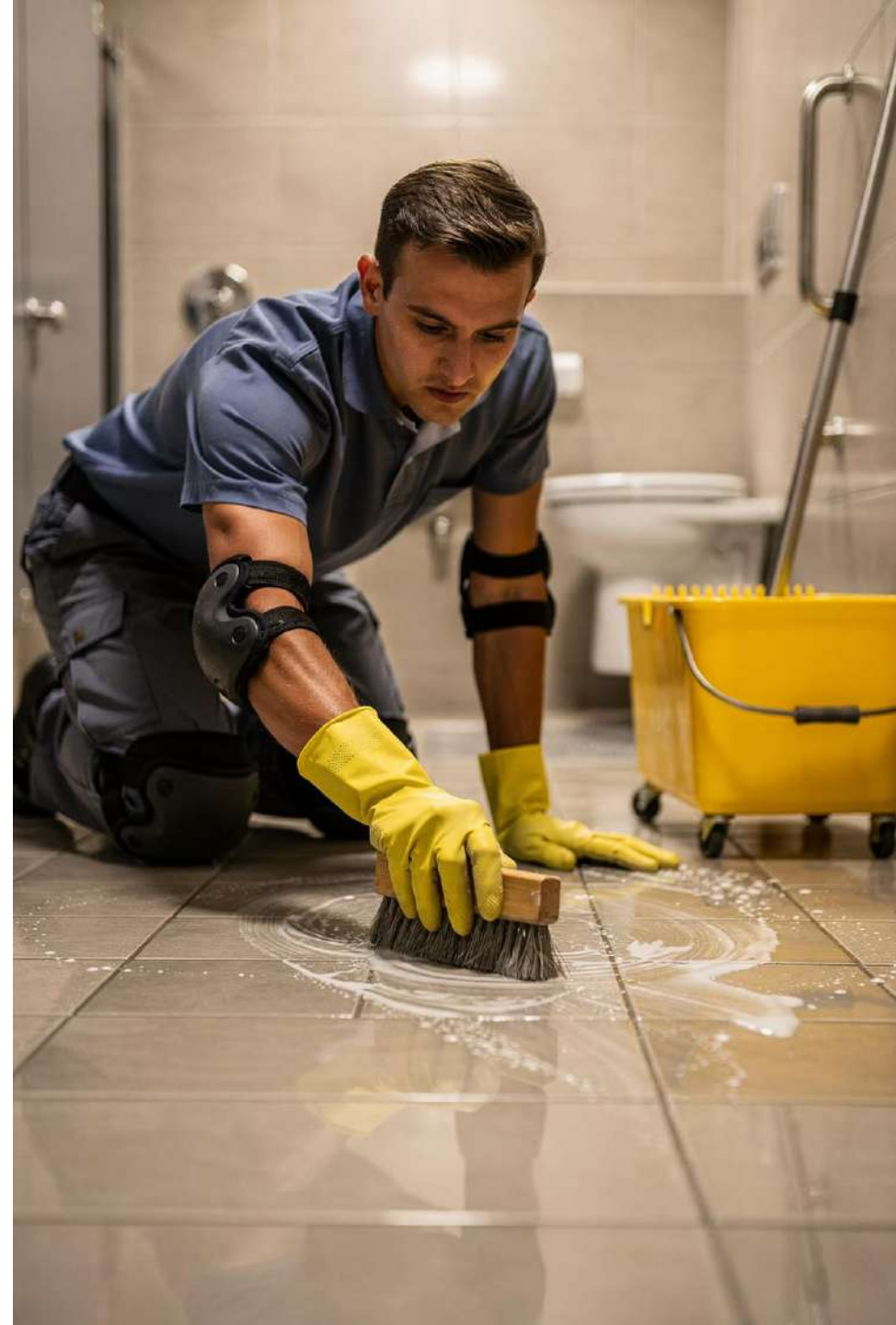

*We obsess over the last step...*

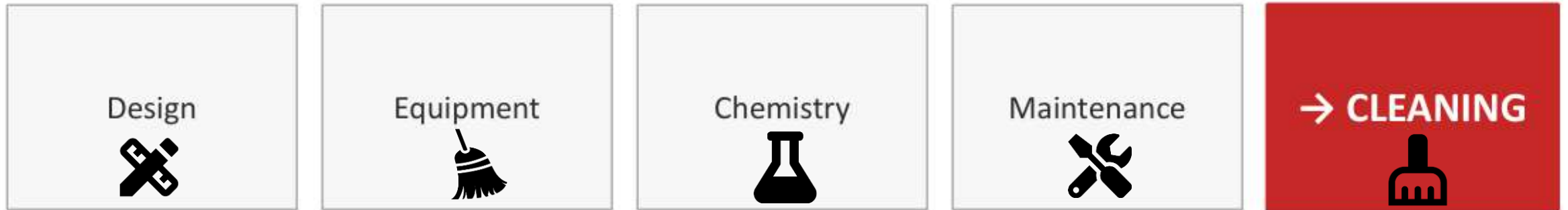

**...while ignoring everything before it.**

Every link matters. One weak link breaks the entire chain.

# Hygiene Is a Chain

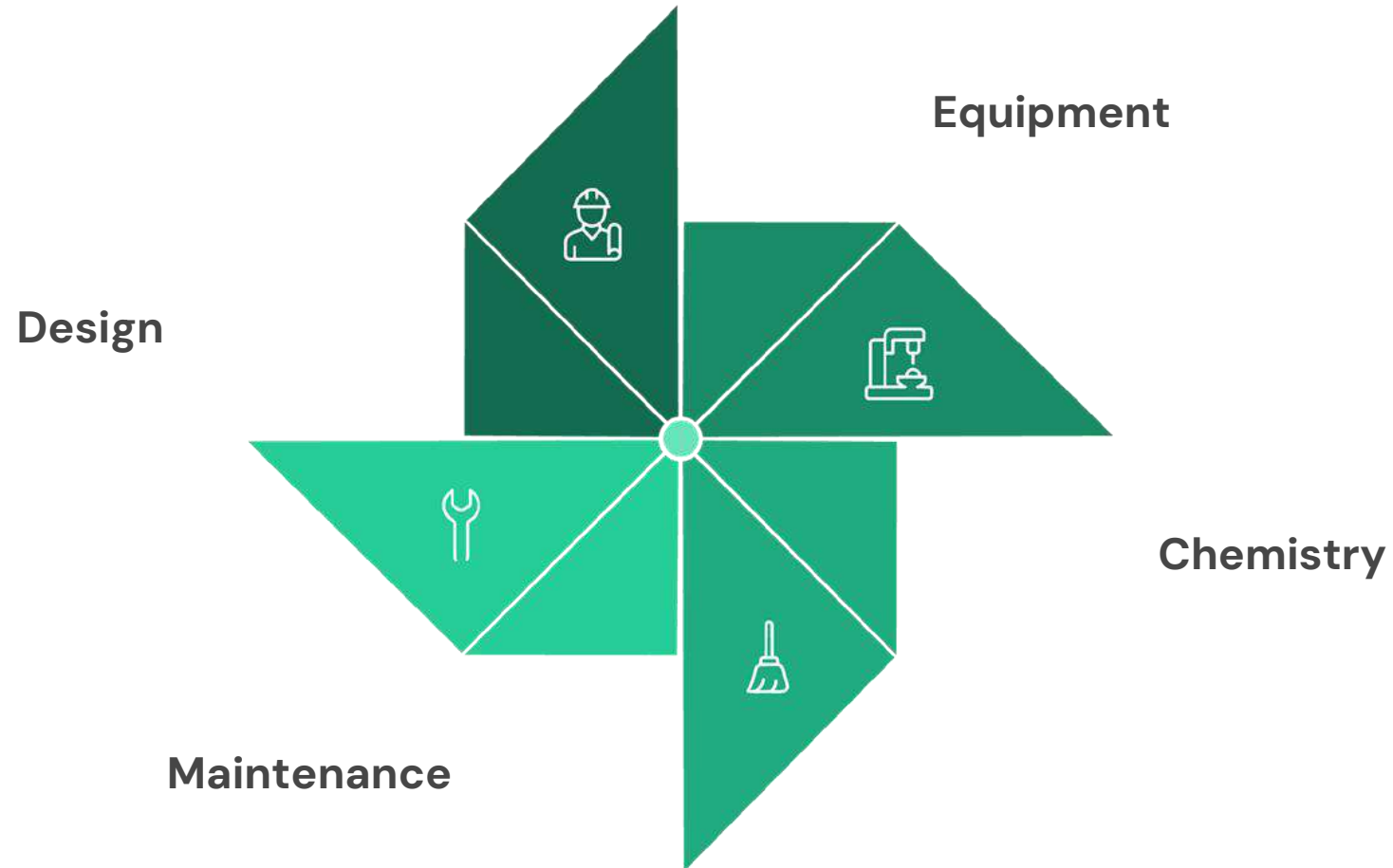

Every link matters. One weak link breaks the entire chain.

# 1-EQUIPMENT

## Hygiene Starts With What You Install



### Urinal Screen

Prevents odor at the source  
and splashing

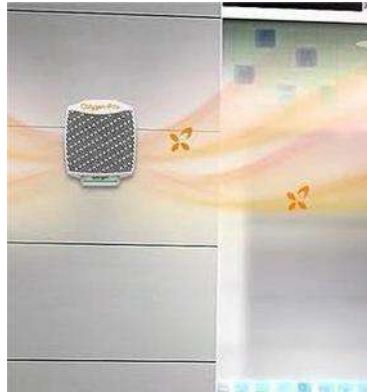

### Continuous

Removes Malodor and  
Odor systems  
masks smell



### Drip Systems

Continuous protection



### Proper

Prevent Waste and  
Dispensers  
hygiene control



### Correct Sanitary Equipment

# 2 Chemistry

## Cleaning Is a

### Chemistry

Right product for the right soil

### Method

Technique determines outcome

### Timing

Dwell time makes chemistry work



# Cleaning is not basic labor.



## Dilution Ratio

Too weak = ineffective. Too strong = residue.

## Contact Time

Wiped too soon = zero kill rate.

## Surface Compatibility

Wrong product destroys grout, sealants, and finishes.

# Different Dirt = Different



**Mineral Scale and Soap Scum**  
Requires acidic descaler



**Organic Waste**  
Needs alkaline surfactant



**Biofilm & Bacteria**  
Demands enzymatic or probiotic action

# More Chemical ≠ Better Result

- ⚠ Overdosing corrodes surfaces, leaves residue, and increases cost — with zero hygiene benefit.



# 3- MAINTENANCE NICE

## You Cannot Clean What Is Broken



### Cracked Grout

Harbors bacteria  
permanently



### Plumbing Problems

Continuous source of rust  
and calcination



### Broken Fittings

Creates ongoing  
contamination risk



### Blocked Drains

Odor and infection source

# 4- Design

## The Washroom Design Problem Nobody Talks About

How suctions, ducts, drains, doors, and ventilation silently destroy hygiene



### 1 Ventilation

- Minimum 10 ACH, zoned extraction
- No shared return ducts

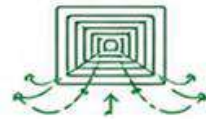

### 2 Drainage

- Centre-placed
- Correct slope gradient
- Sealed P-traps on every fixture

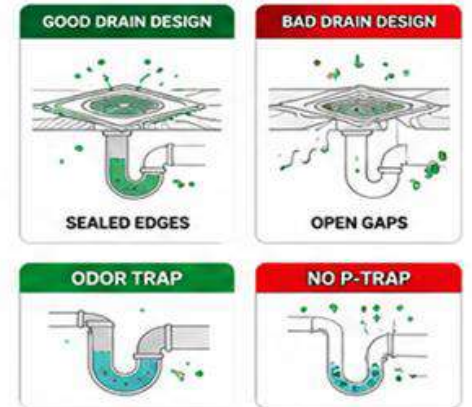

### 3 Fixtures

- Urinal height, toilet clearance, and dispersion modeled in design



### 4 Doors

- Push-to-exit, touchless options
- Outward-opening stalls
- Foot hardware

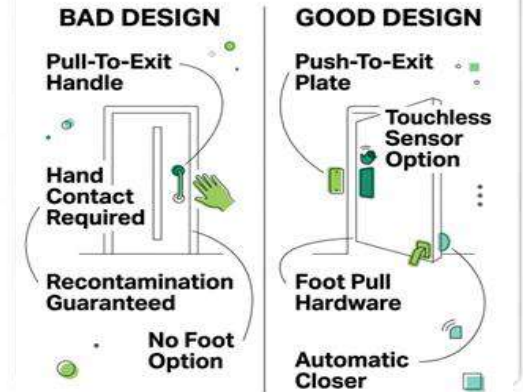

# The Endless Loop



Without a system, you are always reacting. Never solving.

# The Real Cost: What Poor Design

Produces  
**3x**

More cleaning hours

Required in poorly designed washrooms vs well-designed equivalents



**40%**

Of complaints

In facilities trace back to structural or design deficiencies — not cleaning frequency



**80%**

Of odor sources

Are systemic — drain traps, grout porosity, airflow reversal — not surface dirt



~~THE  
TEND  
PROBL~~  
We measure people...

**not results.**

Headcount is not a hygiene KPI. Outcomes are.



# The Reality on the

- ⊗ 2 people doing a 5-person job. The system fails before they even start.



## THE BUDGET TRAP

**Low budget ≠  
Low cost.**

Underinvesting in system creates expensive reactive remediation,  
complaints, and damage.

# The Impossible Choice

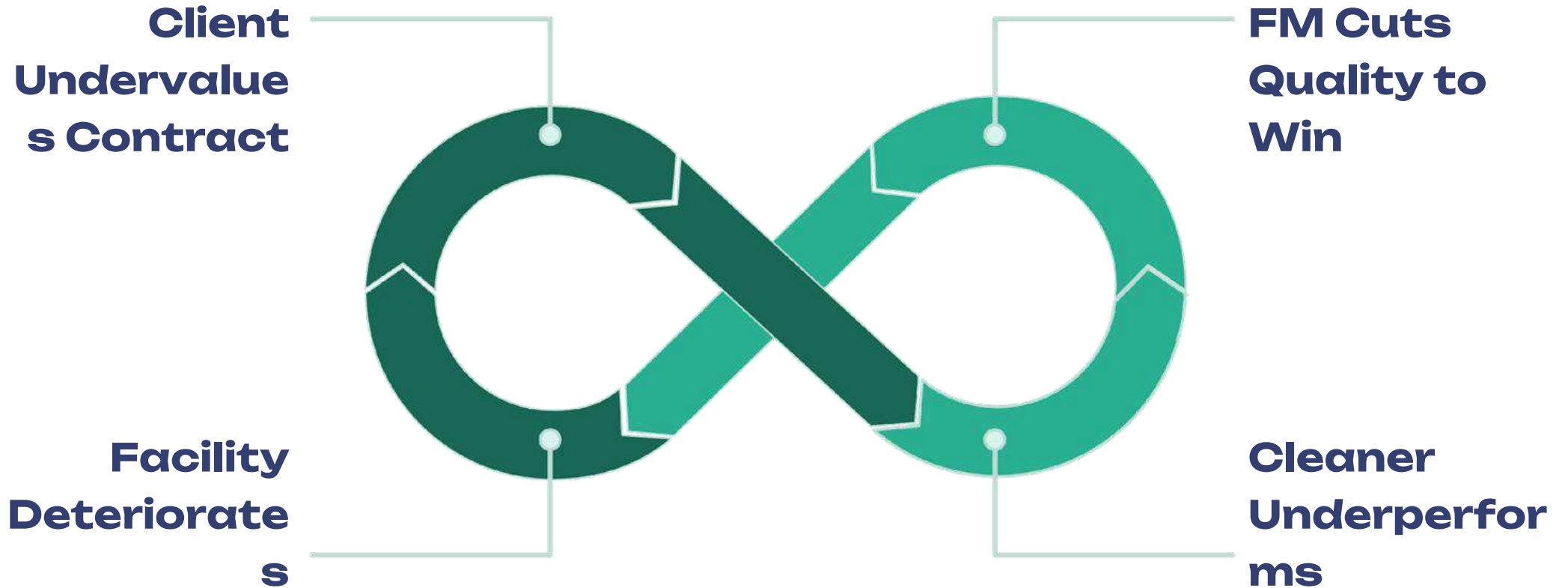

Every player in this cycle has been comfortable pointing at someone else. The structure makes failure inevitable — and then we act surprised.

# The Solution: System Alignment

This cannot be solved by one party alone. It requires all stakeholders working together.



## Designers

Cleanable materials, proper drainage, minimal joints



## Facility Owners

Adequate budgets, maintenance standards, asset care



## FM Companies

Trained staff, correct chemistry, performance measurement



## Suppliers

Right products, proper dosing, technical support

**ROOT  
CAUSE**

**SYSTEM.**

**Not cleaning.**

Powered by



# THANK YOU

